



# RolliCute™

ROBOTIC VACUUM

## USER MANUAL





[www.rollibot.com](http://www.rollibot.com)

**Customer Service: 1-844-585-6295**

# Contents

<b>Section 1. Safety Warnings &amp; Guidelines</b> .....	1
1.1 — Safety Warnings.....	1
1.2 — Disposal at End-of-Life.....	2
<b>Section 2. Parts &amp; Assembly</b> .....	3
2.1 — Box Contents.....	3
2.2 — Components Overview .....	3
2.3 — Battery Information & Installation.....	4
2.4 — Assembly .....	5
<b>Section 3. Usage</b> .....	6
3.1 — Charging .....	6
3.2 — Using .....	8
3.3 — Storing.....	8
<b>Section 4. Maintenance</b> .....	9
4.1 — Removing the Dustbin .....	9
4.2 — Cleaning the Dustbin.....	9
4.3 — Replacing the Filter .....	10
4.4 — Cleaning & Replacing the Brushes .....	11
<b>Section 5. Troubleshooting &amp; Information</b> .....	12
5.1 — General Issues .....	12
5.2 — Status Indicator Issues .....	13
<b>Section 6. Warranty Information</b> .....	15

## Section 1. Safety Warnings & Guidelines

This user manual will guide you through the functions and usage of your RolliBot. It is important that you follow all instructions and regard all notes that appear throughout this manual. Consult this manual before you attempt to use your RolliBot RolliCute. If you have questions not answered by this manual or are in need of repair or non-routine service, contact RolliBot customer service at 1-844-585-6295. Before contacting customer service, please have your model number and purchase information ready as any of these may be needed during the call.

### 1.1 - Safety Warnings

When reading this manual, note these icons:



Notes with this icon **MUST** be read, understood, and obeyed to prevent injury or damage etc.



Notes with this icon include relevant information

### Overall Usage



- RolliCute is for indoor use only.
- Do not use the RolliCute on any other surface besides flooring.
- Do not use the RolliCute on shag carpet, high-pile carpet, tassels, or fabric with loose edges.
- Before using the RolliCute, remove all objects which may easily sustain or cause damage if bumped such as glass decor, loose fabrics like rug tassels or edges, pet food containers, etc.
- Remove all objects which may easily cause damage if cleaned up by the RolliCute or entangled in its brushes including but not limited to small metal objects like nails and screws, and cords/wires.
- RolliCute is not a toy. Do not sit or stand on any part of the device.
- Do not leave children or animals unsupervised around the RolliCute.
- Clean the outside with dry, non-abrasive cloth only. Do not spray water or liquids onto the RolliCute.
- Do not insert objects into the RolliCute or allow the RolliCute to clean up near any part of your body including but not limited to your fingers or hair etc.
- Do not use this device to clean up anything that is burning or smoking.
- Do not place the RolliCute near any source of significant heat or combustible materials including but not limited to lighters, matches, open flames, heaters, or flammable liquids.
- Do not use this device to clean up bleach, paint, or other chemicals, or anything wet.
- Use a physical barrier to prevent access to balconies and ensure safe operation.
- Always turn the RolliCute off before transporting.

## Battery & Charging



- Refer any non-routine battery maintenance to RolliBot.
- Product may not be used with any type of power converter.
- Use only the charger supplied by the manufacturer to charge this device.
- Use only the battery included in the original packaging or received from RolliBot as a replacement.
- Use only the charger included in the original packaging or received from RolliBot as a replacement.
- Do not use a charger with a damaged cord or plug.
- Charge indoors only.
- Keep the charging environment clean and dry.
- Never handle chargers with wet hands.
- Please ensure the charger is fully inserted and/or connected to the wall outlet before charging. Improper insertion may result in electric shock, short circuiting, smoke, or fire.
- Before storing, fully charge the RolliCute to prevent battery over-discharge due to non-use.
- If storing for more than one month, discharge and recharge the battery every three months.
- Store the RolliCute indoors at a dry and stable temperature. Do not store in an unheated garage, shed, or other location with extreme temperature fluctuations.
- Cover the RolliCute to protect it from dust. Do not store in a dusty environment as, with all electronic devices, dust may cause damage over time.
- It is recommended to charge the battery at least 16 hours before using the RolliCute for the first time. Batteries perform best after several full charge/discharge cycles.
- Always disconnect the RolliCute from the charger before cleaning.

### 1.2 – Disposal at End-of-Life

This product must not be disposed of by incineration, landfilling, or mixing with household trash. Improper disposal of the battery contained within this product may result in the battery heating up, rupturing, or igniting which may cause serious injury. The substances contained inside the battery present chemical risks to the environment. The recommended disposal for any RolliCute at its end-of-life is to dispose of the entire unit at or through an e-Waste recycling center, program, or facility. Local regulations and laws pertaining to the recycling and disposal of lithium ion batteries and/or products containing them will vary according to country, state, and local governments. You must check laws and regulations corresponding to where you live in order to properly dispose of the battery and/or unit. It is the user's responsibility to dispose of their waste equipment properly with accordance with local regulations and laws.

For additional information about where you should drop off your batteries and electrical or electronic waste, please contact your local or regional waste-management office, your household waste disposal service, or your point-of-sale.

## Section 2. Parts & Assembly

### 2.1 - Box Contents

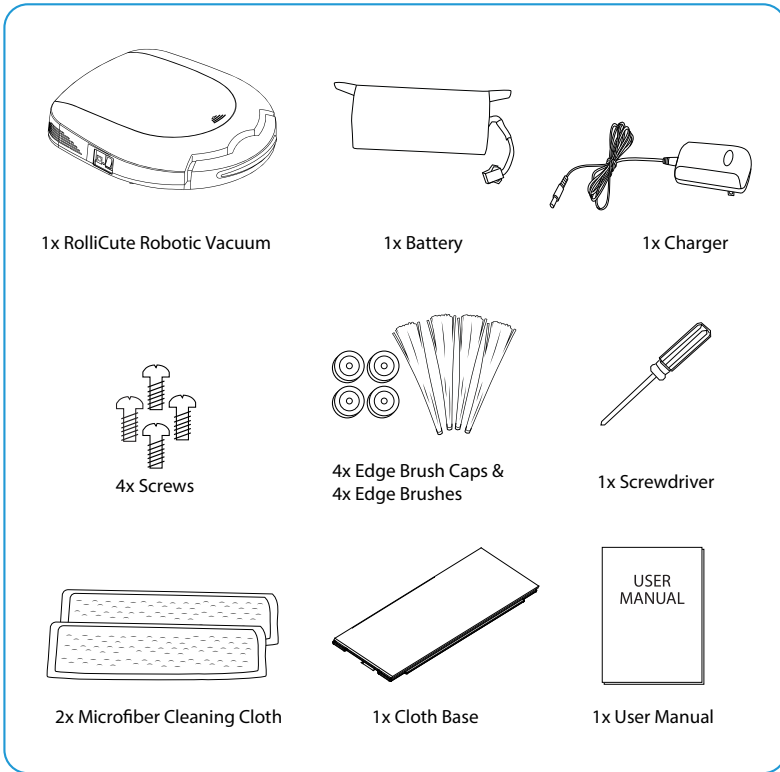

 The RolliCute also contains 1x preinstalled filter.

### 2.2 - Components Overview

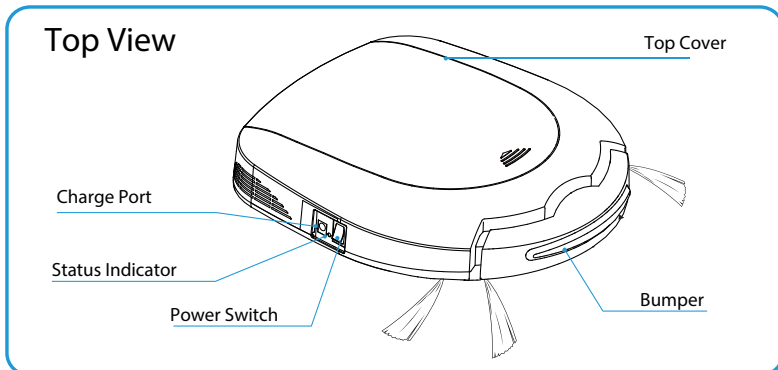

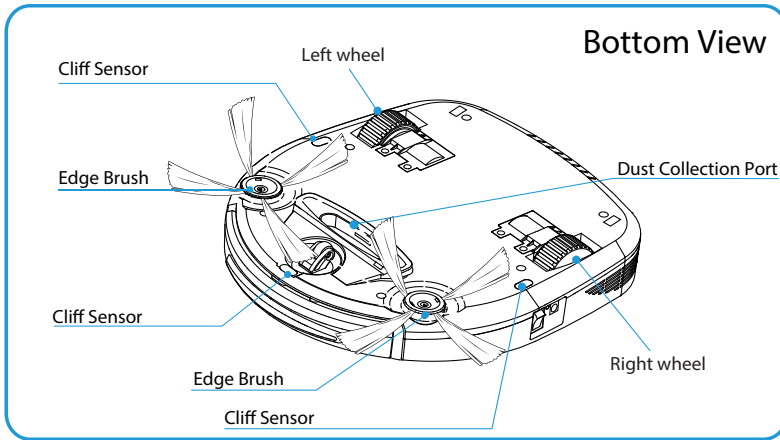

### 2.3 - Battery Information & Installation

The RolliCute comes with a 1500mAh capacity Nickel Metal Hydride (NiMH) rechargeable battery and, when properly cared for, has a 4-5 hour charging time. Install it before proceeding.

**!** Refer any non-routine battery maintenance to RolliBot.

Use only the battery included in the original packaging or received from RolliBot as a replacement.

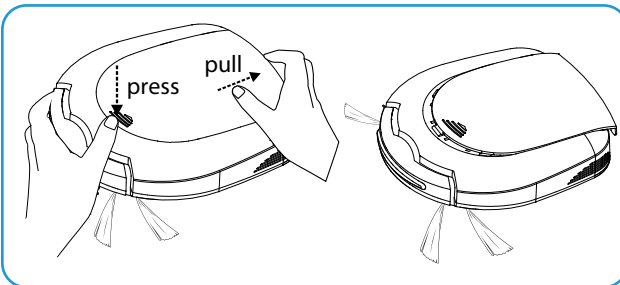

**Step 1.** Using the arrows as a guide, gently press on the top cover and pull it to remove it.

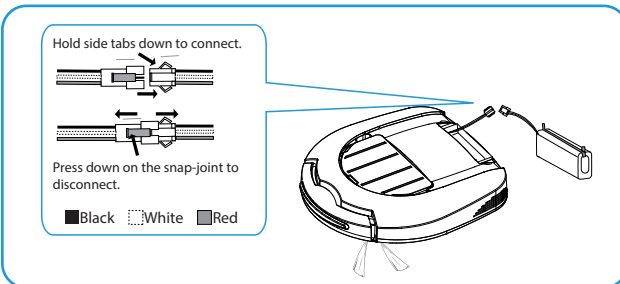

**Step 2.** Locate the battery cords and the RolliCute's cords. Hold down the tabs on each and connect the two.

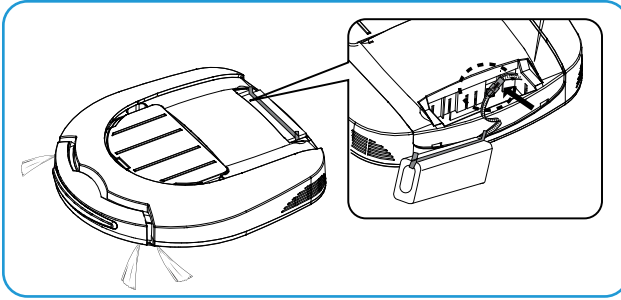

**Step 3.** Carefully push the connected cords into the corner slot.

**Step 4.** Fully insert the battery into its compartment using the tabs on top if needed.

**Step 5.** Replace the top cover.

## 2.4 - Assembly

See the following images and instructions to assemble the outer parts of the RolliCute.

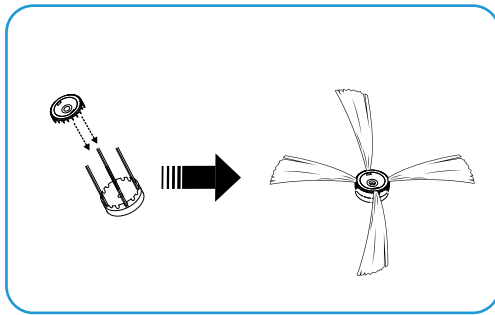

**Step 1.** Thread the bristles of two edge brushes through two edge brush caps then push the caps down until they attach to the brushes.

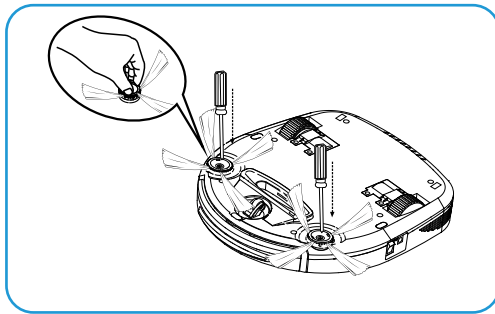

**Step 2.** Turn over the RolliCute and press the edge brushes onto their designated shafts.

**Step 3.** Using the included screwdriver and two of the screws, secure the edge brushes to the underside of the RolliCute.

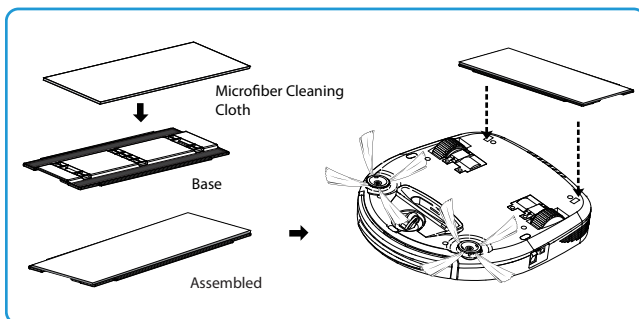

**Step 4.** Optionally, attach a microfiber cleaning cloth to its base. Then, attach the base to the underside of the RolliCute. The cloth may be lightly dampened before attachment if desired.



### Section 3. Usage



- RolliCute is for indoor use only.
- Do not use the RolliCute on any other surface besides flooring.
- Do not use the RolliCute on shag, high pile carpet, tassels, or fabric with loose edges.
- Before using the RolliCute, remove all objects which may easily sustain or cause damage if bumped such as glass decor, loose fabrics like rug tassels or edges, pet food containers, etc.
- Remove all objects which may easily cause damage if cleaned up by the RolliCute or entangled in its brushes including but not limited to small metal objects like nails and screws, and cords/wires.
- RolliCute is not a toy. Do not sit or stand on any part of the device.
- Do not leave children or animals unsupervised around the RolliCute.
- Clean the outside with dry, non-abrasive cloth only. Do not spray water or liquids onto the RolliCute.
- Do not insert objects into the RolliCute or allow the RolliCute to clean up near any part of your body including but not limited to your fingers or hair etc.
- Do not use this device to clean up anything that is burning or smoking.
- Do not place the RolliCute near any source of significant heat or combustible materials including but not limited to lighters, matches, open flames, heaters, or flammable liquids.
- Do not use this device to clean up bleach, paint, or other chemicals, or anything wet.
- Use a physical barrier to prevent access to balconies to ensure safe operation.
- Always turn the RolliCute off before transporting.

### How It Works

The RolliCute can be used for cleaning various surfaces including but not limited low pile carpet (0.5in or 1.5cm), wood or laminate flooring, linoleum, and ceramic tile etc. in indoor environments.

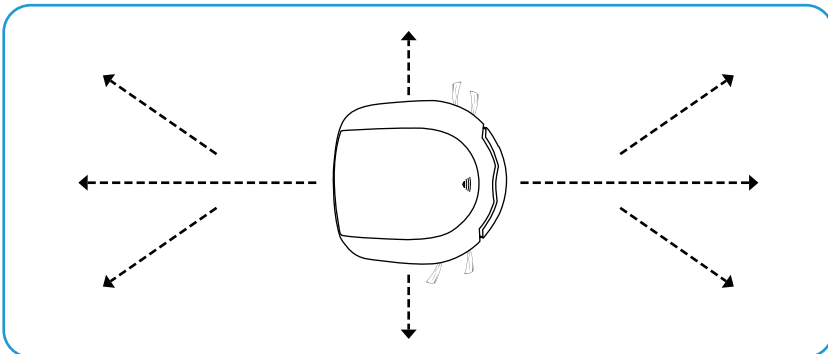

*The RolliCute uses patternless, intelligent movement to cover as much area as possible while its edge brushes actively draw debris inward to ensure it gets cleaned up. If attached, microfiber cloth can sweep or mop up any dust or debris left over.*

### 3.1 - Charging

Before using your vacuum, it must be charged. See the following image and instructions.

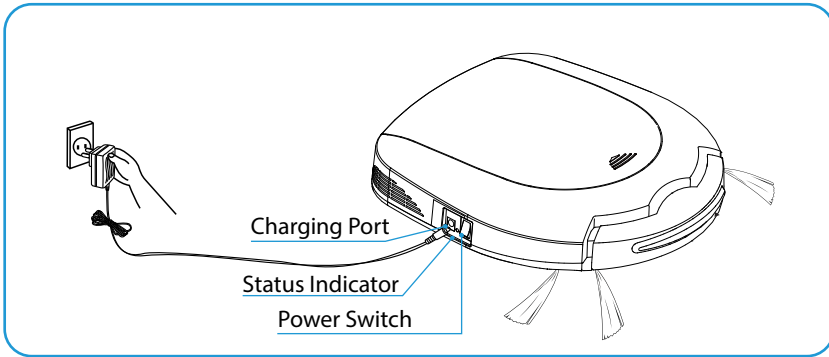

**Step 1.** Locate the charging port on the side of the RolliCute near the power switch.

**Step 2.** Ensure the charging port is dry and otherwise free of debris.

**Step 3.** Plug the charger into the wall then plug the other end into the RolliCute. The Status Indicator will blink during charging.

**Step 4.** When the RolliCute is fully charged, the Status Indicator will stop blinking and remain on. After it is fully charged, disconnect it from the charger.



- It is recommended to charge the battery at least 16 hours before using the RolliCute for the first time. Batteries perform best after several full charge/discharge cycles.
- After the initial charge, the charging time is approximately 4-5 hours. Charging longer may affect battery life.
- If the Status Indicator does not turn on and/or does not blink, check that the charger is connected securely to the wall and to the RolliCute.
- Charge according to these instructions, otherwise the battery may sustain damage.
- If you misplace your charger, please visit our website at [www.rollibot.com](http://www.rollibot.com) for a replacement.



- Product may not be used with any type of power converter.
- Use only the charger included in the original packaging or received from RolliBot as a replacement.
- Do not use a charger with a damaged cord or plug.
- Charge indoors only.
- Keep the charging environment clean and dry.
- If the charging port is damp or obstructed, do not use it.
- Never handle chargers with wet hands.
- Please ensure the charger is fully inserted and/or connected to the wall outlet before charging. Improper insertion may result in electric shock, short circuiting, smoke, or fire.

- Before storing, fully charge the RolliCute to prevent battery over-discharge due to non-use.
- Store the RolliCute indoors at a dry and stable temperature. Do not store in an unheated garage, shed, or other location with extreme temperature fluctuations.
- Always disconnect the RolliCute from the charger before cleaning.

### 3.2 – Using

Before using your vacuum for the first time, ensure it is fully charged, all parts are installed, and your cleaning environment is free of obstacles such as small power cords, pet food containers, and loose fabrics. After this, see the following steps:

**Step 1.** Click the power switch on the side of RolliCute to turn it on. Once on, the Status Indicator will turn on and the brushes will start to rotate as the RolliCute begins a quick self-test.

**Step 2.** Once the self-test is complete and all components are ready, the Status Indicator will turn off and the RolliCute will move randomly as it begins to clean. The average cleaning duration will last approximately 80 minutes.

**Step 3.** After cleaning, the RolliCute will stop. Locate your vacuum, turn it off, and store it in a suitable location.



- Empty the dustbin and clean the brushes and filter after every 3-4 uses.
- When the battery is low, the Status Indicator will blink twice continually or the RolliCute will stop working.
- If there is an issue detected during the self-test, the Status Indicator will blink according to the type of error detected. Refer to Section 5.2 for more details.
- If the RolliCute blinks for any other issue besides a low battery, place it on level ground and restart it. If restarting it does not resolve the issue, contact customer service.

### 3.3 – Storing

Before storing your vacuum, ensure the storing environment is suitable. Properly storing your RolliCute will help improve performance and battery life expectancy.

**Step 1.** Ensure the RolliCute is fully charged. Charge it if needed.

**Step 2.** Turn the RolliCute off.

**Step 3.** Store the RolliCute indoors at a dry and stable temperature.



- Always turn the RolliCute off before transporting.
- Before storing, fully charge the RolliCute to prevent battery over-discharge due to non-use.
- If storing for more than one month, discharge and recharge the battery every three months.
- Store the RolliCute indoors at a dry and stable temperature. Do not store in an unheated garage, shed, or other location with extreme temperature fluctuations.
- Cover the RolliCute to protect it from dust. Do not store in a dusty environment as, with all electronic devices, dust may cause damage over time.

## Section 4. Maintenance

As with proper storage, proper maintenance will help improve your RolliCute's performance. Periodically, the RolliCute's dustbin will need to be emptied and its filter changed. Please make sure your vacuum is completely powered off before performing any type of maintenance.

- ❗ • Clean the outside with dry, non-abrasive cloth only. Do not spray water or liquids onto the RolliCute.
- Do not insert objects into the RolliCute or allow the RolliCute to clean up near any part of your body including but not limited to your fingers or hair etc.
- Do not perform any maintenance when the power is on or the battery is charging.

### 4.1 - Removing the Dustbin

See the following images and instructions.

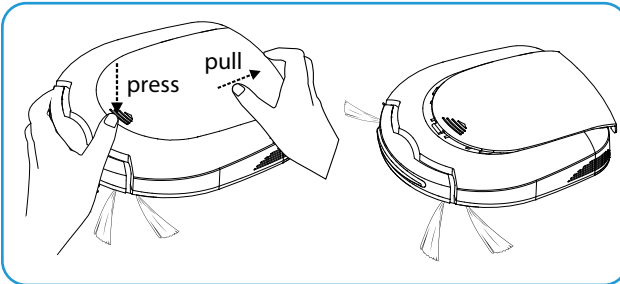

**Step 1.** Using the arrows as a guide, gently press on the top cover and pull it to remove it.

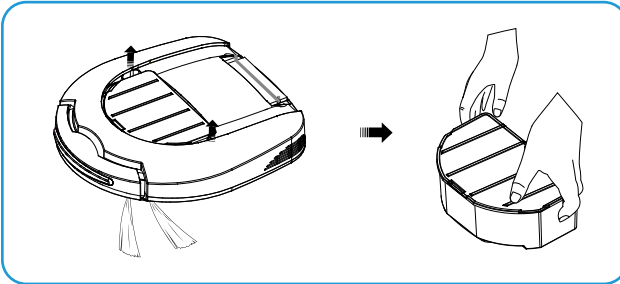

**Step 2.** Locate the dustbin. Using the notches at either side, grasp the dustbin and carefully lift it out of the RolliCute.

## 4.2 - Cleaning the Dustbin

The dustbin should be removed and cleaned after every 3-4 periods of substantial cleaning or as needed. See the following images and instructions.

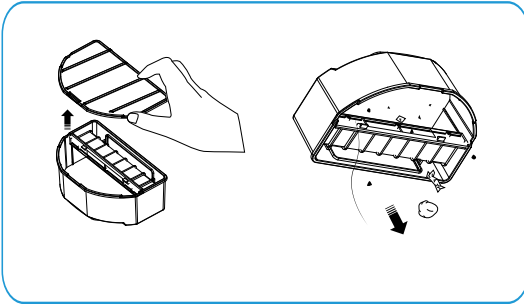

**Step 1.** After removing the dustbin, push the edges of the lid up to lift it off and remove it.

**Step 2.** Dump out the dustbin. If needed, remove and tap the filter to shake off any debris.

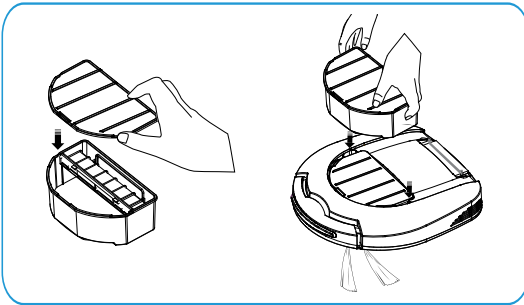

**Step 3.** Replace the dustbin lid and press the edges to securely reattach it.

**Step 4.** Put the dustbin back inside the RolliCute and replace the top cover.



- The dust box and filter can be cleaned with water if needed. After rinsing, fully dry both the dustbin and filter before placing them back in the RolliCute. If not fully dried, the RolliCute's internal parts may be damaged or the filtering may not work.
- Failure to regularly empty the dustbin will keep the RolliCute from working properly.

## 4.3 - Replacing the Filter

The RolliCute comes with one pre-installed filter. To purchase additional filters, please visit our website at [www.rollibot.com](http://www.rollibot.com). Additional filters may be changed as needed. See the following images and instructions.

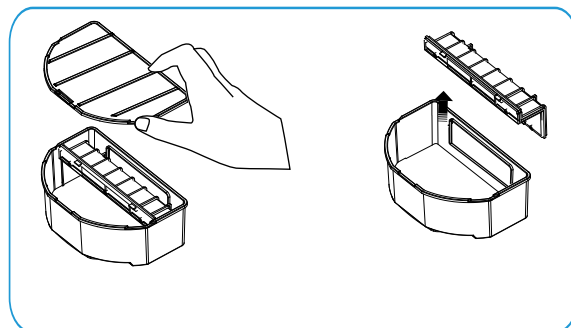

**Step 1.** Remove the dustbin and its lid to locate the filter, then remove the filter.

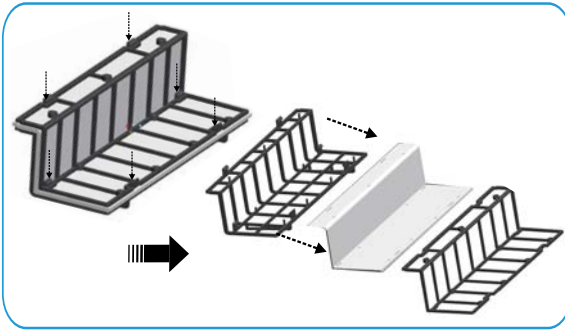

**Step 2.** Push open each of the four tabs to separate the filter brackets.

**Step 3.** Pull the filter from its brackets.

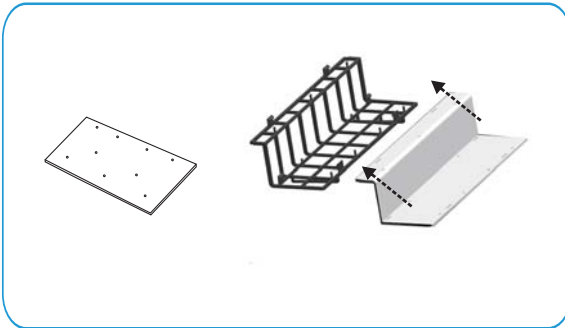

**Step 4.** Using a new or cleaned and dried filter, push it onto the filter bracket's pegs.

**Step 5.** Reassemble the filter brackets and check that the four tabs are securely closed.

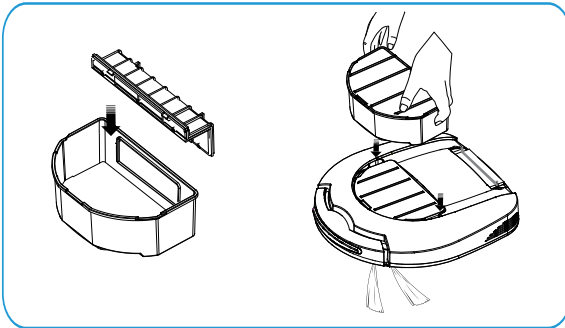

**Step 6.** Put the filter back inside the dustbin.

**Step 7.** Put the dustbin back inside the RolliCute and put the top cover back on.

#### 4.4 - Cleaning & Replacing the Brushes

The RolliCute comes with four edge brushes, two for initial installation and two extra to use as replacements. See the following image and instructions for information on how to clean and replace the edge brushes.

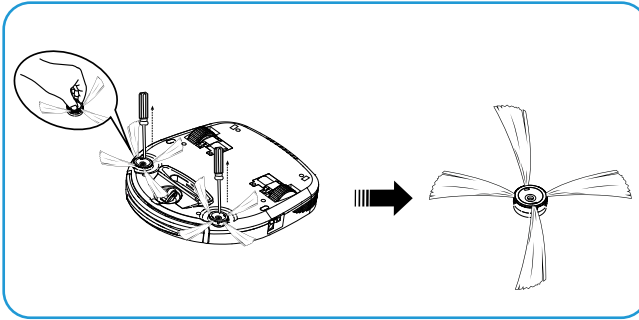

**Step 1.** Turn over the RolliCute and use the included screwdriver to unfasten the screws and remove the edge brushes from their designated shafts.

**Step 2.** Tap the brushes to shake off any debris. If there are any items twisted or caught in the bristles, carefully pull these out by hand.

**Step 3.** Rinse the brushes with water and allow them time to dry completely.

**Step 4.** Ensure the brushes are dry and reinstall them on the bottom of the RolliCute.

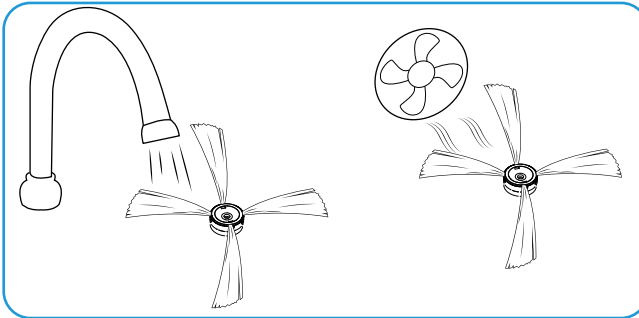

To replace the brushes, discard the old brushes and install new ones.

**Step 1.** Thread the bristles of two edge brushes through two edge brush caps then push the caps down until they attach to the brushes.

**Step 2.** Turn over the RolliCute and press the edge brushes onto their designated shafts.

**Step 3.** Using the included screwdriver and two of the screws, secure the edge brushes to the underside of the RolliCute.

## Section 5. Troubleshooting & Information

### 5.1 – General Issues

**Q:** Why did the RolliCute suddenly get louder?

**A:** Something may have gotten stuck on the bottom of the RolliCute. Turn off the RolliCute and check the underside for debris or blockages. Clear away any obstructions.

**Q:** Why did the RolliCute stop working?

**A:** The RolliCute may have encountered an issue. Check the Status Indicator near the power switch. If it is blinking, refer to the next section for more information.

**Q:** The RolliCute is stuck, what should I do?

**A:** Turn off the RolliCute and check underneath. Something may be stuck in or on the underside. If uneven terrain is the issue, place something heavy and durable atop the uneven edge. If the RolliCute enters this area, it should bump into the obstacle and avoid it rather than attempting to move forward.

**Q:** The RolliCute fell down the steps. Are the cliff sensors working?

**A:** There may be an issue with the sensors. Check the bottom of the RolliCute around the sensors for dust or debris and clean as needed. Additionally, you can check the top of the stairs for excess debris or obstacles.

**Q:** Why does the RolliCute retreat during cleaning?

**A (1):** The lighting may be generating heat. Do not have the RolliBot operate under direct sunlight.

**A (2):** The carpeting or floor surface may be too dark and/or causing issues with the sensors. The RolliCute may recognize dark surfaces as cliffs or edges.

**Q:** Why isn't the RolliCute picking up dirt or debris?

**A:** Likely, the dustbin is full. Clean out the dustbin and brushes and restart cleaning.

### 5.2 – Status Indicator Issues

When the RolliCute encounters errors certain issues, the Status Indicator next to the power switch will blink in different patterns to communicate the issue. Count the number of blinks in the pattern and refer to the table below.

Blink Number	Cause	Solution(s)
0	RolliCute is fully charged	No issue. The RolliCute should operate as normal.
1	RolliCute is charging	No issue. Continue charging as needed. Average charging time is 4-5 hours.
2	Battery is low	Connect the RolliCute to its charger and allow it to recharge.
3	Bumper error	Check the bumper for debris or blockage. Clean as needed.
4	Cliff sensor error	Check the cliff sensor surfaces for debris or blockage. Clean as needed.



<b>5</b>	<b>Main brush error</b>	<b>Check the brush bristles for tangles or blockage. Clean as needed.</b>
<b>6</b>	<b>Left wheel error</b>	<b>Check the wheels for debris or blockage. Clean as needed.</b>
<b>7</b>	<b>Right wheel error</b>	<b>Check the wheels for debris or blockage. Clean as needed.</b>
<b>8</b>	<b>Fan error</b>	<b>Clean the entire RolliCute and restart it.</b>

*If the information in Sections 5.1 or 5.2 does not resolve your issue, please visit our website at [www.rollibot.com](http://www.rollibot.com) or contact customer support 1-844-585-6295.*

## Section 6. Warranty Information

### One Year Limited Hardware Warranty

YOUR ROLLICUTE ROBOTIC VACUUM (“PRODUCT”) INCLUDES A ONE YEAR LIMITED HARDWARE WARRANTY (“WARRANTY”). THE WARRANTY COVERS PRODUCT DEFECTS IN MATERIALS AND WORKMANSHIP UNDER NORMAL USE. THIS WARRANTY IS LIMITED TO RESIDENTS OF THE UNITED STATES AND CANADA ONLY AND IS AVAILABLE ONLY TO ORIGINAL PURCHASERS. THIS WARRANTY GIVES YOU SPECIFIC LEGAL RIGHTS AND YOU MAY ALSO HAVE OTHER RIGHTS WHICH VARY FROM STATE TO STATE.

THIS WARRANTY STARTS ON THE DATE OF YOUR PURCHASE AND LASTS FOR ONE YEAR (THE “WARRANTY PERIOD”). THE WARRANTY PERIOD IS NOT EXTENDED IF THE PRODUCT IS REPAIRED OR REPLACED. WE MAY CHANGE THE AVAILABILITY OF THIS LIMITED WARRANTY AT OUR DISCRETION, BUT ANY CHANGES WILL NOT BE RETROACTIVE.

WARRANTY SERVICES ARE PROVIDED BY WARRANTY PRO. IF A HARDWARE DEFECT ARISES AND A VALID CLAIM IS RECEIVED WITHIN THE WARRANTY PERIOD, AT ITS OPTION AND TO THE EXTENT PERMITTED BY LAW, ROLLIBOT WILL: (1) REPAIR THE HARDWARE DEFECT BY USING NEW OR REFURBISHED PARTS THAT ARE EQUIVALENT TO NEW IN PERFORMANCE AND RELIABILITY; OR (2) EXCHANGE THE PRODUCT WITH A PRODUCT THAT IS NEW OR REFURBISHED WHICH IS SUBSTANTIALLY EQUIVALENT TO THE ORIGINAL PRODUCT. THIS WARRANTY IS FOR ONE REPLACEMENT ONLY OF LIKE-ITEMS AND DOES NOT COVER ITEMS OUT OF PRODUCTION IF THE PRODUCT IS NO LONGER MADE OR STOCKED. THIS WARRANTY IS NOT ASSIGNABLE OR TRANSFERABLE. THE ORIGINAL PURCHASER MAY CALL ROLLIBOT’S TOLL-FREE NUMBER AT 1-844-585-6295 FOR SERVICE REQUEST.

WHEN A PRODUCT OR PART IS EXCHANGED, ANY REPLACEMENT ITEM BECOMES YOUR PROPERTY AND THE REPLACED ITEM BECOMES ROLLIBOT’S PROPERTY. THIS WARRANTY ONLY COVERS TECHNICAL HARDWARE DEFECTIVENESS DURING THE WARRANTY PERIOD AND UNDER NORMAL USE CONDITIONS. ROLLIBOT DOES NOT WARRANT UNINTERRUPTED OR ERROR-FREE OPERATION OF THIS PRODUCT.

THIS WARRANTY DOES NOT COVER ANY DAMAGE DUE TO: (A) TRANSPORTATION; (B) STORAGE; (C) IMPROPER USE; (D) FAILURE TO FOLLOW THE PRODUCT INSTRUCTIONS OR TO PERFORM ANY PREVENTIVE MAINTENANCE; (E) MODIFICATIONS; (F) UNAUTHORIZED REPAIR; (G) NORMAL WEAR AND TEAR; OR (H) EXTERNAL CAUSES SUCH AS ACCIDENTS, ABUSE, OR OTHER ACTIONS OR EVENTS BEYOND OUR REASONABLE CONTROL.

IMPORTANT: DO NOT DISASSEMBLE THE PRODUCT. DISASSEMBLING THE PRODUCT WILL VOID THIS WARRANTY. ONLY ROLLIBOT OR A PARTY EXPRESSLY AUTHORIZED BY ROLLIBOT SHOULD PERFORM SERVICE ON THIS PRODUCT.

DISCLAIMER OF WARRANTY: THE REMEDIES DESCRIBED ABOVE ARE YOUR SOLE AND EXCLUSIVE REMEDIES AND OUR ENTIRE LIABILITY FOR ANY BREACH OF THIS LIMITED WARRANTY. OUR LIABILITY SHALL UNDER NO CIRCUMSTANCES EXCEED THE ACTUAL AMOUNT PAID BY YOU FOR THE DEFECTIVE PRODUCT, NOR SHALL WE UNDER ANY CIRCUMSTANCES BE LIABLE FOR ANY CONSEQUENTIAL, INCIDENTAL, SPECIAL OR PUNITIVE DAMAGES OR LOSSES, WHETHER DIRECT OR INDIRECT.

SOME STATES DO NOT ALLOW THE EXCLUSION OR LIMITATION OF INCIDENTAL OR CONSEQUENTIAL DAMAGES, SO THE ABOVE LIMITATION OR EXCLUSION MAY NOT APPLY TO YOU.

THE DURATION AND REMEDIES OF ALL IMPLIED WARRANTIES, INCLUDING WITHOUT LIMITATION THE WARRANTIES OF MERCHANTABILITY AND FITNESS FOR A PARTICULAR PURPOSE ARE LIMITED TO THE DURATION OF THIS EXPRESS LIMITED WARRANTY.

