



# ROLLICOOL®

Portable Air Conditioner

COOLING

10,000 BTU

Model No.

COOL 410

Rollibot.com

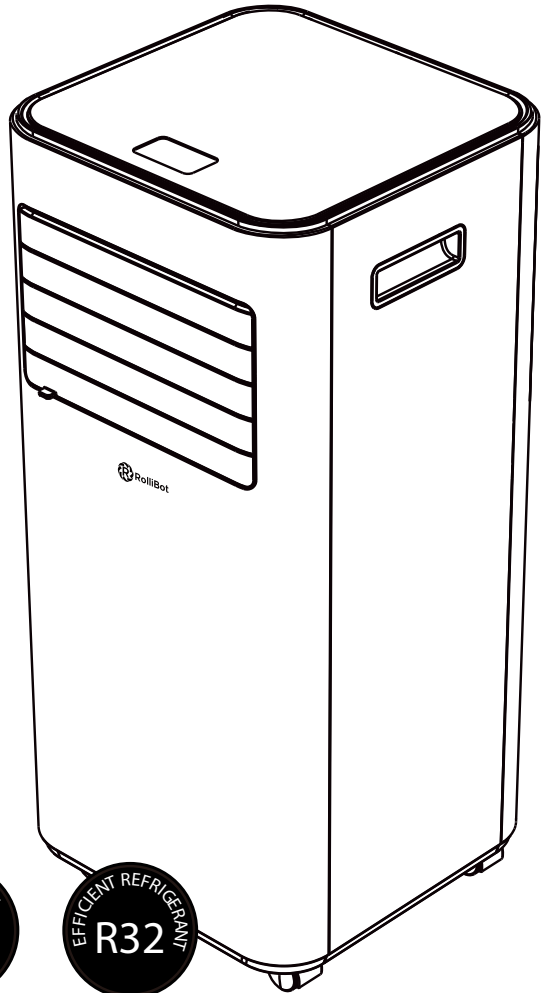

Advanced Remote Technology-

Turn it on and off from anywhere!

## USER MANUAL

In order to continue serving our customers and providing the best products, our product information including our user manuals may receive updates from time to time. Please check our website for the latest user manuals and product materials.



[www.rollibot.com](http://www.rollibot.com)

**Customer Service: 1-844-585-6295**

Dear Rollibot RolliCool Owner,

Welcome to the new age of cool!

The RolliCool 410 is an air conditioner that uses the latest technology to improve your quality of life. We've designed this unit to be fully portable and easy to use in your home. It features multiple modes to keep you comfortably cool on hot days and dry during humid nights.

The RolliCool 410 is designed for indoor use and can be used in different sized spaces. Casters make it easy to move the unit from room to room so you can stay comfortable anywhere.

All of the unit's features are available through the RolliCool app. After pairing your unit with your smartphone, you'll be able to stay comfortable however you like!

Thank you for being a part of the Rollibot family!

— The RolliBot Team

# Contents

- Section 1. Information & Safety Warnings .....5
  - 1.1 – Introduction .....5
  - 1.2 – Safety Warnings .....5
  - 1.3 – FCC Information.....6
  - 1.4 – Disposal at End-of-Life.....6
- Section 2. RolliCool Parts .....7
  - 2.1 – Box Contents.....7
  - 2.2 – Components Overview .....7
  - 2.3 – Control Panel.....8
  - 2.4 – Remote Overview .....10
  - 2.5 - Tips for Optimal Use .....11
- Section 3. Setting Up the Unit .....12
- Section 4. Wireless Setup.....15
  - 4.1 – App Installation.....15
  - 4.2 – App Installation.....16
  - 4.3 – Amazon Alexa Setup .....17
- Section 5. How to Use the RolliCool .....18
  - 5.1 – Timer .....18
  - 5.2 – Fan Mode .....18
  - 5.3 – Cool Mode.....18
  - 5.4 – Dehumidify Mode .....19
  - 5.5 – Sleep Mode .....19
  - 5.6 – Automatic Defrost.....19
  - 5.7 – Overload Protection .....19
- Section 6. Maintenance.....20
  - 6.1 – How to Clean the Filters .....20
  - 6.2 – How to Drain the Unit.....20
- Section 7. Storage .....21
- Section 8. Troubleshooting.....21
- Section 9. Warranty .....22
  - 9.1 – Violation .....22
  - 9.2 – Information.....23

## Section 1. Information & Safety Warnings

### 1.1 – Introduction

This user manual will guide you through the functions and usage of your RolliCool 410 Portable AC unit. It is important that you follow all instructions and pay attention to all notes that appear throughout this manual. Consult this manual before you attempt to use your RolliCool. If you have questions not answered by this manual or are in need of repair or non-routine service, contact customer service at 1-844-585-6295. Before contacting customer service, please have your purchase information ready as this may be needed during the call. This information may be recorded below.

Date of Purchase: \_\_\_\_\_

Place of Purchase: \_\_\_\_\_

### 1.2 – Safety Warnings

When reading this manual, note these icons:



- Notes with this icon **MUST** be read, understood, and obeyed to prevent injury or damage, etc.



- Notes with this icon include relevant information.



#### Overall Usage

- Do not insert objects into the product.
- The product is not a toy. Do not leave children unsupervised around the product.
- The product is designed for indoor use only.
- Keep the product upright at all times.
- Do not use the product near any of the following places:
  - Near anything flammable
  - Direct sunlight
  - Damp areas
  - Dusty areas
- Do not use wax, thinner, or solvents when cleaning the air conditioner.
- Clean your filters once or more every couple of weeks.
- Do not place any obstacles in front of the air inlet or outlet.
- Do not pull on the power cords or cables.
- In the event that the product is malfunctioning, shut the power off immediately.
- Switch off the product before cleaning.
- Only use parts you have received from RolliBot® or that have been included in the original packaging.
- Do not use the product for any purpose other than described in this user manual.



#### Installation Warnings

- Do not install the product in a sloped setting.
- Do not install the product in direct sunlight.
- Do not install the product in places with open flames or flammable gas.
- Do not use extension cords etc. Only plug the product into a grounded wall outlet.
- Avoid installing the product in damp areas.
- Make sure to drain the product with the included drainage pipe.

### 1.3 – FCC Information

#### DECLARATION OF CONFORMITY:

This device complies with Part 15 of the FCC Rules.

Operation is subject to the following two conditions: (1) This device may not cause harmful interference, and (2) this device must accept any interference received, including interference that may cause undesired operation.

#### FCC RELATED INFORMATION:

This equipment has been tested and found to comply with the limits for a Class B digital device, pursuant to Part 15 of the FCC Rules. These limits are designed to provide reasonable protection against harmful interference in a residential installation. This equipment generates, uses, and can radiate radio frequency energy and, if not installed and used in accordance with the instructions, may cause harmful interference to radio communications. However, there is no guarantee that interference will not occur in a particular installation. If this equipment does cause harmful interference to radio or television reception, which can be determined by turning the equipment off and on, the user is encouraged to try to correct the interference by one or more of the following measures:

- Reorient or relocate the receiving antenna.
- Increase the separation between the equipment and receiver.
- Connect the equipment to an outlet on a circuit different from that to which the receiver is connected.
- Consult the dealer or an experienced radio/TV technician for help.

The manufacturer is not responsible for any radio or TV interference caused by unauthorized modifications to this equipment. Such modifications could void the user's authority to operate the equipment.

### 1.4 – Disposal at End-of-Life

This product must not be disposed of by incineration, landfilling, or mixing it with household trash. Improper disposal of the battery contained within this product may result in the battery heating up, rupturing, or igniting which may cause serious injury. The refrigerants contained inside the RolliCool present chemical risks to the environment. The recommended disposal for any RolliCool 410 Portable AC unit at its end-of-life is to dispose of the entire unit by contacting your local recycling company. Local regulations and laws pertaining to the recycling and disposal of any RolliCool unit and/or products containing them will vary according to your country, state, and local governments. You must check laws and regulations corresponding to where you live in order to dispose of your RolliCool unit properly. It is the user's responsibility to dispose of their equipment properly in accordance with local regulations and laws.

For additional information about where you should drop off your RolliCool unit, please contact your local or regional waste management office, your household waste disposal service, or your point-of-sale.

## Section 2. RolliCool Parts

### 2.1 – Box Contents

- 1x RolliCool 410 Portable A/C Unit
- 1x Remote Control
- 1x Drainage Tube
- 1x Window Kits
- 1x Exhaust Hose Outer Connector
- 1x Exhaust Hose Inner Connector
- 1x Exhaust Hose



Remote Control

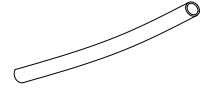

Draining Tube

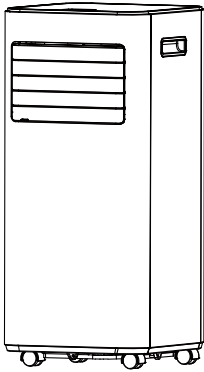

RolliCool 410 Portable A/C Unit



Window Kits



Exhaust Hose Outer Connector



Exhaust Hose Inner Connector



Exhaust Hose

### 2.2 – Components Overview

- 1 Control Panel
- 2 Closed Air Vents (non-oscillating)
- 3 Front Housing
- 4 Casters
- 5 Open Air Vents (non-oscillating)

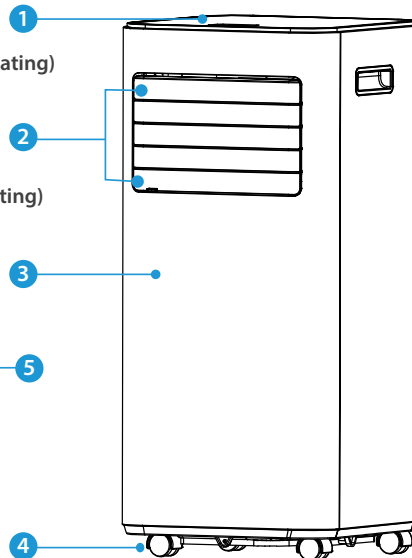
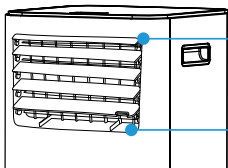

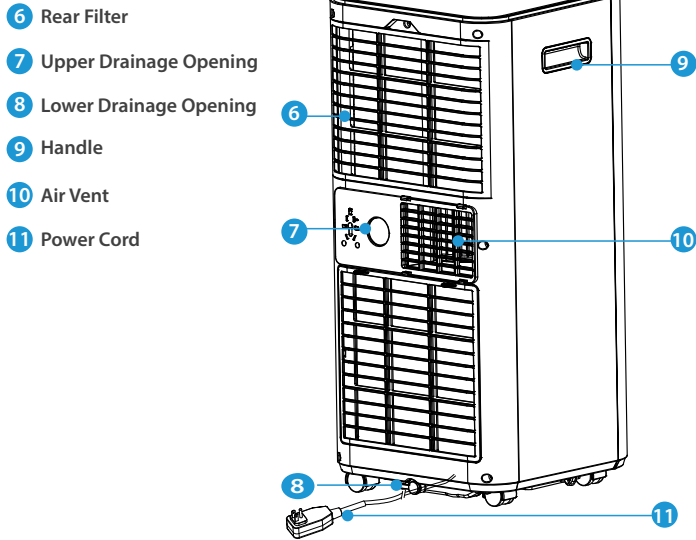

## 2.3 – Control Panel

The 410 features an LED control panel which turns on when the unit turns on and includes on-screen buttons.

### Buttons & Parts (Top View)

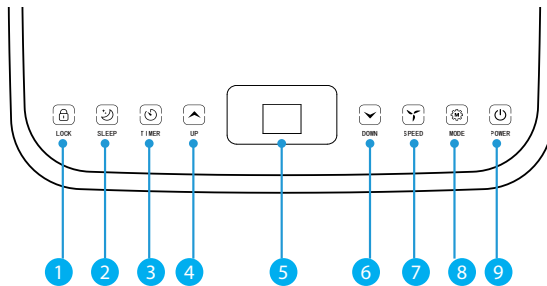







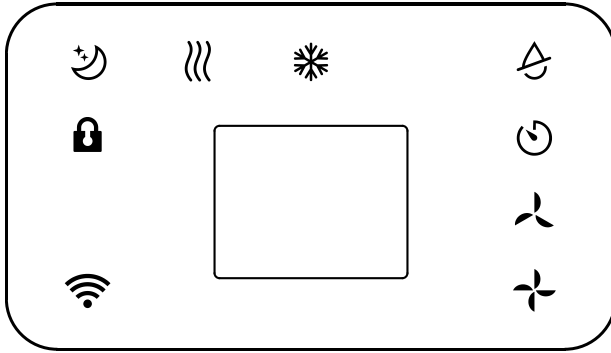

- 1 **Lock Button:** Long press to turn on or off the child lock function.
- 2 **Sleep Button:** Press to turn on or off sleep mode (Sleep mode can only be used in Cool Mode).
- 3 **Timer Button:** Press to turn timer mode on or off.
- 4 **Up Button:** Press to raise the temperature or adjust timer duration.
- 5 **Display:** This section will light up to show temperature and other information.
- 6 **Down Button:** Press to lower temperature or adjust timer duration.
- 7 **Speed:** Press to cycle through 2 fan speeds (High or Low).
- 8 **Mode Button:** Press to cycle between cool, dehumidify, and fan modes.
- 9 **Power Button:** Press to turn the unit on or off.



## Display Icons

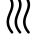



-  **Sleep Mode:** This icon will light up when sleep mode is open.
-  **Lock Function:** This icon will light up when the child lock function is on.
-  **WIFI:** This icon will blink during the unit is connecting to the cell phone via wifi or Bluetooth, then it will light up when the unit is connected the cell phone successfully.
-  **High:** This icon will light up when the speed is high.
-  **Low:** This icon will light up when the speed is low.
-  **Timer Mode:** This icon will light up when the timer has been programmed.
-  **Fan Mode:** This icon will light up when the unit is in fan mode.
-  **Cool Mode:** This icon will light up when the unit is in cool mode.
-  **Dehumidify Mode:** This icon will light up when the unit is in dehumidify mode.

- 
  - Scheduling can be done and/or adjusted via the control panel or the app. See [Section 4](#) for information about the app.
  - The control panel displays Fahrenheit temperature as default, and it can be changed to display Celsius temperature if need.

## 2.4 – Remote Overview

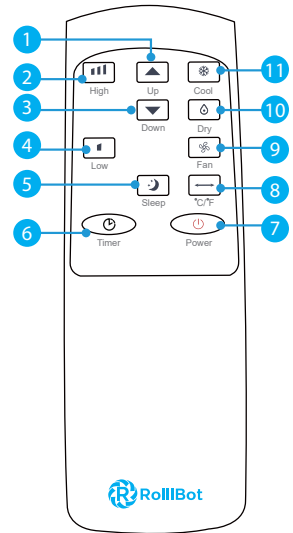
- 1 UP Button:** Press to raise temperature or adjust timer duration.
- 2 High:** Press to switch fan speed to high.
- 3 Down Button:** Press to lower temperature or adjust timer duration.
- 4 Low:** Press to switch fan speed to low.
- 5 Sleep Mode:** Press to turn on or off sleep mode (Sleep mode can only be used in Cool Mode).
- 6 Timer:** Press to turn timer mode on or off.
- 7 Power Button:** Press to turn the unit on or off.
- 8 °C/°F Button:** Press to switch between Celsius and Fahrenheit.
- 9 Fan Mode:** Press to switch to fan mode.
- 10 Dehumidify Mode:** Press to switch to dehumidify mode.
- 11 Cool Mode:** Press to switch to cool mode.



-  Avoid pressing two remote buttons simultaneously as this may cause malfunctions.
- Avoid using the remote in areas with extreme temperature fluctuations.
- If the remote will not be used for extended periods of time, remove the battery.
- The remote control's range is approximately 23 ft. Use it within this range.
- Use only two AAA batteries with the included remote. Do not mix old and new batteries or batteries from different brands.

## 2.5 - Tips for Optimal Use

Follow these recommendations to get the most out of your RolliCool performance:

1. Close windows and doors in the room to be cooled.

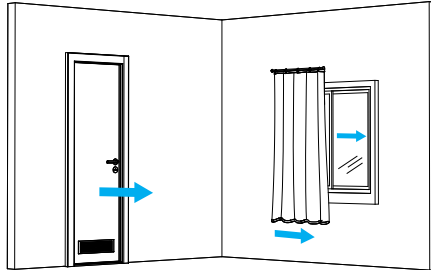

Always close the doors and windows while using the AC.  
(Close shutters and drapes for better cooling performance.)

2. Close or partially close window curtains and/or blinds to prevent direct sunlight from entering the room.

(Direct sunlight hitting the AC unit may cause the unit's temperature sensor to misread the actual temperature in the room. This may cause the unit to keep running, even if the room has been adequately cooled.)

3. Make sure the AC unit is standing on a flat, level surface.
4. Do not cover the AC unit or block the air intake/outlets.



### DO NOT COVER

Never obstruct the air outlet or intake grilles.

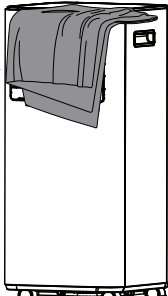

### Upper Drain Opening

For use with continuous draining in dehumidify mode and in cool mode in high-humidity area.

(Drain pan not included.)

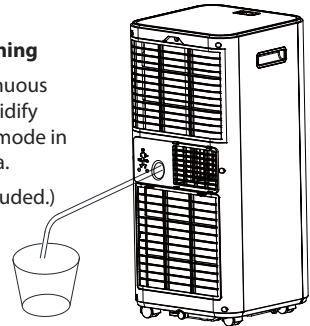

5. Do not use in rooms with excessive humidity (e.g., bathrooms, laundries).
6. Regularly inspect air filters and clean when necessary.
7. Remove/minimize sources of excessive heat from the room.
8. Always connect the upper drainage tube when using cool or dehumidify modes.
9. Always connect the exhaust hose to the window kit for proper ventilation.
10. Keep the exhaust hose as short and free of curves as possible.
11. Do not use outdoors.

## Section 3. Setting Up the Unit

- ! • Before using the unit, keep it upright for at least two hours.
- Do not use extension cords etc. Only plug the unit into a grounded wall outlet.
- Do not use the unit in bathrooms or other excessively humid environments.
- After installation, place the unit on a firm, level surface in an area with at least 19.6 in. of free space around it to allow for proper air circulation.

### Installation – Part 1 of 4: Prepare the Unit

**Step 1.** Keep the unit upright for at least 2 hours.

**Step 2.** Select the perfect placement for the unit that includes:

- unobstructed access to a window
- unobstructed direct access to a power outlet
- flat, level surface
- at least 11.8" from walls or other obstructions
- adequate space for water runoff when using the upper drainage hole (required for cool and dehumidify modes)

**Step 3.** Test the unit's placement:

- verify the AC unit has direct, unobstructed access to a grounded outlet (do not use an extension cord)
- carefully unfurl the exhaust hose and adjust its length to reach the window

! • Keep the exhaust hose as short and free of curves as possible. Make sure the exhaust hose remains unobstructed and free of sharp bends and bends.

🌀 For best results, add weather stripping to your window to improve hold on the window kit and reduce cooled air loss.

### Installation – Part 2 of 4: Water Drain

! • Do not skip this step. To avoid unit failure, you must connect the upper drain hose when using cool and/or dehumidify mode or operating in humid environments.

**Step 1.** Locate the upper drainage hole on the back of the unit. Set a large container close to the drainage hole for water runoff.

**Step 2.** Remove the cap from the upper drainage hole.

**Step 3.** Place one end of the draining tube in the container and connect the other end to the unit's upper drainage hole.

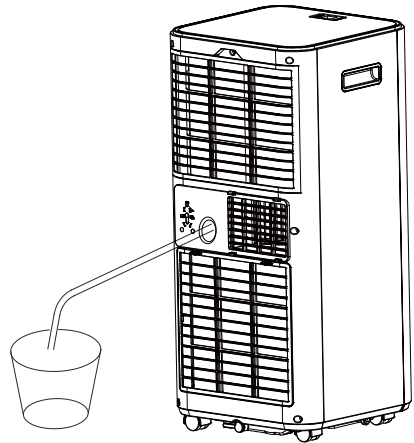

- 🌀 • If the draining tube is too stiff and/or cannot be attached, try soaking the end in hot water to soften it first.
- For optimal experience, use a large container for water drainage. Container should not exceed height of the upper drainage hole.

## Installation – Part 3 of 4: Exhaust Hose

 Do not skip this step. You must attach the exhaust hose to the window kit for proper ventilation.

 Make sure that the unit is placed in a flat position and that air vents are not blocked or obstructed.

**Step 1.** Insert the connectors into both ends of the exhaust hose. Rotate the connectors clockwise to tighten.

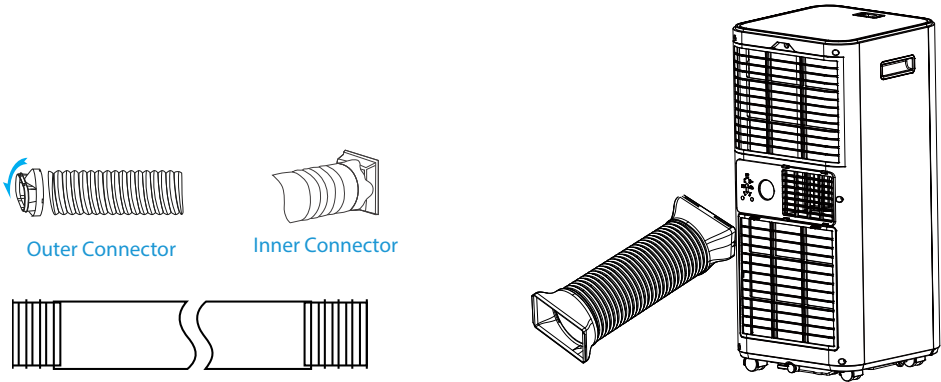

**Step 2.** Slide the exhaust hose onto the air vent on the back of the unit. Make sure to use the inner connector.

 Keep the exhaust hose as short and free of curves as possible. Make sure it is free from sharp bends and kinks, as this may inhibit airflow and/or damage the unit.

## Installation – Part 4 of 4: Window Kit

### Window Kit Parts

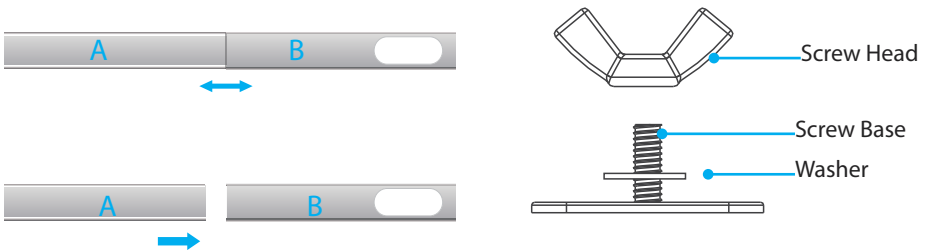

### Sections

These sections thread into one another and should be placed within a window gap.

### Screw Fastener

These parts are used to secure the sections together and can be loosened or tightened when adjusting the sections according to window height.

## Installation

**Step 1.** Separate one screw fastener and thread the screw base into one end of Section B (1).

**Step 2.** Thread Section A onto the end of Section B (2), and use the screw head and washer to secure the sections together (3).

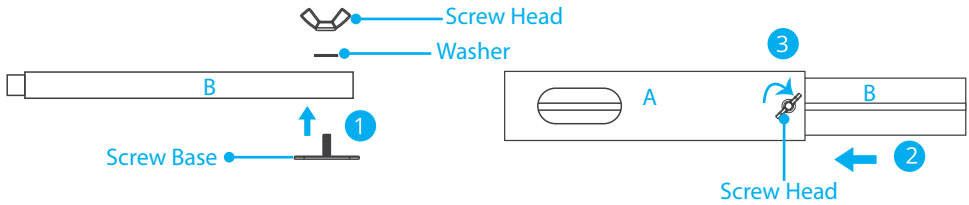

**Step 3.** Install the assembled window kit into the gap between the window and the frame. Close the window to secure it. It needs to hold the windows kit firmly in place, and secure the window kit with duct tape if required. It is recommended that the gap between the adapter and the sides of the window should be sealed off for maximum efficiency.

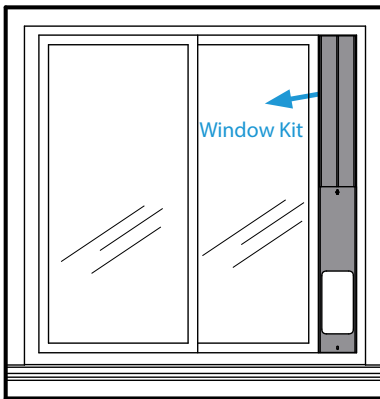

Slide Window

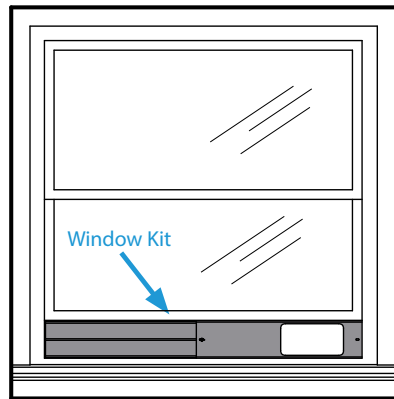

Hung Window

**Step 4.** Carefully unfurl the exhaust hose to reach the window. Affix the outer connector of the hose to the window kit's air outlet.

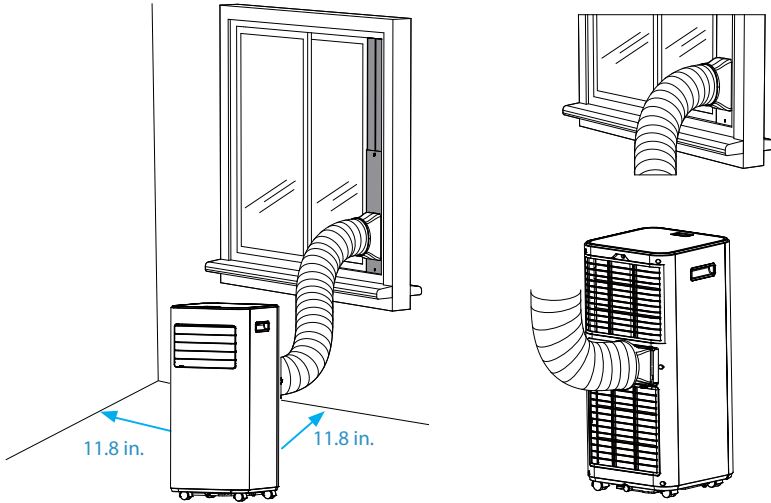

- *Make sure the exhaust hose remains unobstructed and free from sharp bends and kinks, as this may inhibit air flow and/or damage the unit.*
- *For smaller windows, the window kit can be cut for a better fit using a hacksaw or some other large cutting tool. Do not use hand scissors, kitchen knives or other small cutting utensils.*
- *Make sure the exhaust hose is not bent or kinked as this may inhibit air flow and/or damage the unit.*
- *Make sure that the unit is placed in a flat position and the air outlet is not blocked*
- *Make sure the unit is placed at least 11.8 in. (30 cm) away from the wall.*

## Section 4. Wireless Setup

The RolliCool app can be used to control most features on the AC unit. The app is compatible with most Android and iOS smartphones. Additionally, the unit can also be paired with Alexa and other products from the Amazon Echo Family.

 *You must have the RolliCool app on your smartphone to use Alexa with the RolliCool.*

### 4.1 – App Installation

**Step1.** Use your smartphone to search the Play or App Store for the “RolliCool” application.

**Step2.** Download and install the app according to your operating system.

## 4.2 – App Installation

When pairing to the app, your mobile device and the AC unit must be on the same Wi-Fi network.

- Bluetooth® is enabled and will stay enabled as long as the RolliCool is turned on.
- For instructions on how to turn on Bluetooth®, consult materials for your smartphone.
- As with most Bluetooth® devices, it is recommended to keep the connected devices within 32 ft. from each other. The connection may be terminated or fail to work properly if the connected devices are too far apart.

**Step 1.** Turn on the AC unit, then turn on your smartphone's Bluetooth. Open the Rollicool app.

**Step 2.** Register for an account. Then sign in with your Rollicool account details on the app (fig. 1) to log in. If you already have a Rollibot account, simply log in.

**Step 3.** Tap the “Add Device”  icon at the lower left corner to go next step.

**Step 4.** Tap the access mode Bluetooth (fig.2). Enter access details as needed.

**Step 5.** Select a nearby device to pair. The “WIFI” light should start blinking; after which, the app should begin pairing.

**Step 6.** After connecting successfully, the “WIFI” light will stay on, and the app can be used to set cooling schedules, change cooling modes and more (fig. 3).

 Your device may had a different model name by default. To change the device name, tap “More” in the upper corner then select “Rename device” to enter a new name for your COOL 410. **Do not use “AC”, “A/C”, “A-C”, or similar iterations, as this will interfere with some Alexa features.**

-  After powered down for an extended time, the RolliCool app may not automatically sync with your RolliCool once you turn the unit back on. Wait a few minutes, then restart the AC unit. Follow the pairing steps to pair your smartphone with the unit again.
- After pairing successfully, if you can't control the device immediately, you may have a network delay problem. Simply wait a moment and try again to use the app to control the device.

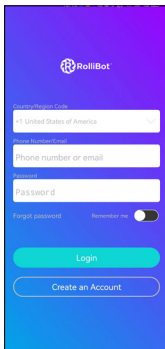

Fig. 1

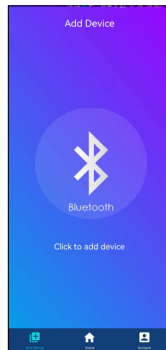

Fig. 2

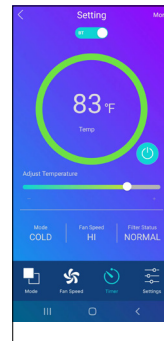

Fig. 3



## 4.3 – Amazon Alexa Setup

**Step 1.** Search “RolliCool” in the Amazon Alexa app home screen (fig. 4).

**Step 2.** Select the RolliCool app and tap “ENABLE” (fig. 5).

**Step 3.** Login to your RolliCool account and tap “Link Now”. Follow any additional in-app instructions as needed (fig. 6).

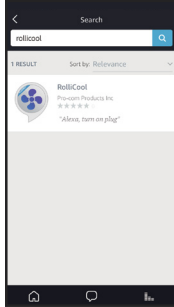

Fig. 4

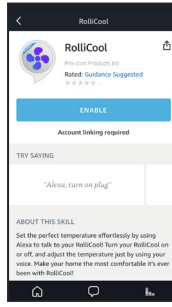

Fig. 5

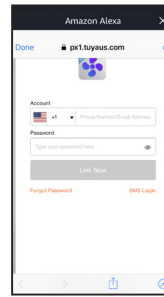

Fig. 6

**!** *Change the name of your RolliCool 410 before pairing with Alexa; otherwise, Alexa won't be able to identify the default name (RolliCool-smart-12517). **Do not use "AC", "A/C", "A-C", or similar iterations, as this will interfere with some Alexa features.** Most features can be used by pressing the buttons on the unit's control panel, through Alexa voice commands, or via the Rollicool app.*

### List of Alexa Commands:

1. "Turn on <device name>": Powers on the RolliCool 410.
2. "Turn off <device name>": Powers off the RolliCool 410.
3. "Set temperature to <degree>": Sets RolliCool temperature to specified number.

- 🌀** • *Make sure Amazon Alexa app and RolliCool are connected to the same wi-fi; otherwise, Alexa may not be able to discover your AC unit.*
- *Make sure you're connecting to a stable wi-fi network. If your wi-fi is unstable, Alexa may disconnect and/or work correctly with your RolliCool.*
- *You must have the RolliCool app on your smartphone to use Alexa with the RolliCool.*

## Section 5. How to Use the RolliCool

The COOL410 features a number of ways to keep comfortable. Most features can be used by pressing the buttons on the unit's control panel or via the app.

-  • In most cases, the app can be used as an alternative control method.
- You must attach the drainage tube to the upper draining opening when using cool or dehumidify modes. See [Section 3](#) for more information.
- You must connect the exhaust tube to the window for proper ventilation. See [Section 3](#) for more information.

### 5.1 – Timer

With this mode, the unit will automatically turn on or off and regulate temperature according to the selected times.

-  • Turning on the timer mode when the unit is OFF will set the number of hours before the unit will turn on (see below).
- Turning on the timer mode when the unit is ON will set the number of hours the unit will turn off (see below).
- After setting the timer, the AC unit will enter timer mode. While in this mode, the unit will operate according to the selected timer duration. Pressing the timer button again will turn timer mode off and cancel any duration setting.

#### To Set a Turn On Time

1. When the unit is OFF, press the timer button on the control panel or remote.
2. Use the up and down buttons to select the time the AC unit will turn on. For example, selecting "03" will prompt the unit to turn on in 3 hours.
3. After the selection is complete, the "03" number will flash for ~5s and the display's Timing light will turn on, indicating the Timer function is set successfully.

 When a schedule is active, the unit will not turn on if the chosen temperature is higher than the indoor temperature.

#### To Set a Shut off Time

1. When the unit is ON, press the timer button on the control panel or remote.
2. Use the up and down buttons to select the time the AC unit will turn off. For example, selecting "03" will prompt the unit to turn off in 3 hours.
3. After the selection is complete, the "03" number will flash for ~5s and the display's Timing light will turn on, indicating the Timer function is set successfully.

### 5.2 – Fan Mode

With this mode, the unit will turn on and begin using the fan to promote air circulation.

1. Press the power button on the control panel or remote.
2. Press the mode button on the control panel or remote until the display's FAN light turns on.
3. Use the speed button to switch between fan speeds.

### 5.3 – Cool Mode

With this mode, the unit will turn on and regulate temperature as selected.

1. Press the power button on the control panel or remote.

2. Press the mode button on the control panel or remote until the display's COOL light turns on.
3. Use the up and down buttons to set the desired temperature 62~86°F (16~30°C).
4. Use the speed button to switch between fan speeds.



*In cool mode, the unit will not turn on if the chosen temperature is higher than the indoor temperature.*



*You must attach the drainage tube to the upper draining opening when using cool mode.*

## 5.4 – Dehumidify Mode

With this mode, the unit will turn on and begin removing moisture from the air.

1. Connect the drainage tube to the upper drainage opening. Set a container near the unit to collect the water (if needed). Then place the other end of the drainage tube in the container.
2. Press the power button on the control panel.
3. Press the mode button on the control panel or remote until the display's DEHUM light turns on.



*You must attach the drainage tube to the upper draining opening when using dehumidify mode.*



*In dehumidify mode, the fan speed is automatically set to low and cannot be adjusted.*

## 5.5 – Sleep Mode

When Sleep Mode is activated, the unit will gradually increase the temperature by up to 4°F over the first two hours. Once the initial 2-hour period has elapsed, the temperature will remain constant until Sleep Mode is turned off or until a maximum of 12 hours has passed.

1. Press the power button on the control panel or remote.
2. Press the sleep button on the remote to turn this mode on.



*In sleep mode, the fan speed is automatically set to auto and cannot be adjusted.*

## 5.6 – Automatic Defrost

At low room temperatures, frost may buildup at the evaporator during operation. The unit will automatically start defrosting and the POWER LED blinking. The defrost control sequence is as follows:

- A. When the unit operates in the cooling operation, drying operation, the ambient temperature sensor senses the evaporator coil temperature is below 30°F, after the compressor will stop operating for 10 minutes or the coil temperature up to 44°F, the unit restart to cool operating mode.
- B. When the unit operates in the drying operation, once the coil temperature sensor senses the temperature of the evaporator is below 104°F and the differential temperature between coil temperature and room temperature is below 66°F after the compressor operation for 20minutes, the unit starts defrosting for 5 minutes and the power indicator blinking.

## 5.7 – Overload Protection

In the event of a power loss, to protect the compressor there is a 3-minute delay until the compressor restarts.

## Section 6. Maintenance

Proper maintenance will help improve your RolliCool's performance. Periodically, the RolliCool will need its filters cleaned. For optimal performance, the filters should be cleaned at least twice a month.

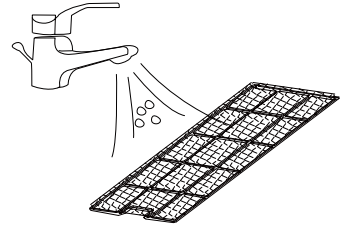

- ! *If any type of non-routine maintenance is needed, such as any maintenance not described in Section 6 of this manual, please contact customer service or a certified HVAC professional as the unit contains refrigerant.*
- Wipe the exterior clean with non-abrasive cloth. If needed, cloth can be dampened with water.*
- Do not use harsh chemicals to clean as these may damage the unit.*

### 6.1 – How to Clean the Filters

- ! *Please make sure your AC unit is completely powered off before performing any type of maintenance.*
- Do not scrape the air filter.*
- A hand vacuum may be used to clean the filter.*
- Reinstall the filter after cleaning. Do not use the RolliCool without the filter.*
- If water has been used to clean the filter, ensure it is completely dried before reinstalling. Do NOT dry the filter in direct sunlight or a drying appliance. Allow the filter to air dry.*

### Cleaning the Filters

1. Reach under the notches and remove the two rear filters. Soak both filters in lukewarm water or use a vacuum to clean the filters. Mild detergents may be used.
2. After the filters have completely dried, reinstall the two rear filters.

### 6.2 – How to Drain the Unit

In most cases, the AC unit will not require draining. In the event that draining is necessary, the unit will sound an alarm (~10s Beep sound) and the display's "FL" light will turn on to indicate the water reservoir inside is full.

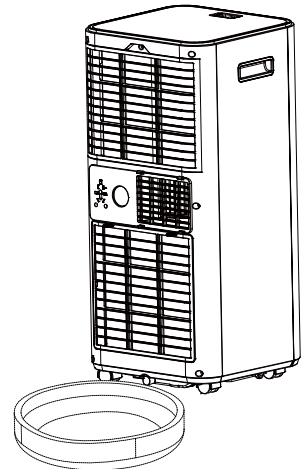

- 🌀 *Please make sure your AC unit is completely powered off before performing any type of maintenance.*
- If relocating the unit before draining, move it carefully so as not to spill the water inside the reservoir.*
- Make sure the drainage pipe has adequate space underneath for draining. If using the lower drainage opening, ensure there is a suitable area for water runoff. If using the upper drainage opening, fetch a container for water runoff before connecting the tube.*
- Keep the drainage cover and the water plug on at all times when not draining the unit.*
- When draining the unit, do not allow the power cord to come in contact with water.*
- During drainage, the unit may be tilted slight backwards to promote faster drainage.*
- Keep in mind the unit may hold more water than expected. Do not use a small container to drain. Or drain the RolliCool 410 outdoors.*

## Using the Lower Drainage Openings

1. Turn off and unplug the unit. If necessary, carefully move it to a suitable location for drainage.
2. Set a container near the unit for water run off, then place the end of the draining tube in the container.
3. Remove the cap from the lower drainage opening and connect the draining tube to the unit via the opening.

 *If the draining tube is too stiff and/or cannot be attached, try soaking the end in hot water to soften it first.*

4. Allow the water to drain.

 *After draining is complete, it is recommended to turn the unit on and run it in Fan Mode at the lowest speed for at least two hours in order to ensure the unit dries inside.*

5. Detach the tube and reinstall the cap.

## Section 7. Storage

Store your RolliCool 410 in a dry, indoor environment. Properly storing your RolliCool will help improve performance and battery life expectancy.

**Step 1.** Turn the AC unit off.

**Step 2.** Remove the exhaust hose and window kit as needed for storage with the unit.

**Step 3.** Drain the unit of any water and ensure all parts are completely dry.

**Step 4.** Turn the unit on and run it in fan mode at the lowest speed for at least two hours in order to ensure the inner reservoir is dried inside.

**Step 5.** Turn off the unit and install the power cord's plug into its fixture on the back of the unit.

**Step 6.** Remove the remote batteries and store them separately.

-  *Always turn the unit off before transporting or storing.*
- Cover the unit to protect it from dust. Do not store in a dusty environment. As with all electronic devices, dust may cause damage over time.*
- Store the unit indoors at a dry and stable temperature. Do not store in an unheated garage, shed, or other locations with extreme temperature fluctuations.*

## Section 8. Troubleshooting

Problem	Possible Cause(s)	Solution(s)
The unit does not power on.	There is no electricity.	Turn it on after connecting it to a socket with electricity.
	The overflow indicator is on.	Drain the water inside.
	The system is protected	Wait 3 minutes until the temperature is lowered then restart the unit.
The cooling effect is weak.	There is direct sunlight.	Cover any direct sunlight coming through the windows.
	Doors or windows are open; there are a lot of people; or there are other sources of heat nearby.	Close doors and windows.
	The filter is dirty.	Clean or replace the filter.
	The air inlet or outlet is blocked.	Clear obstructions.

Problem	Possible Cause(s)	Solution(s)
Excessive noise	The unit is not placed on a flat surface.	Place the unit on a flat and stable surface.
Leaking while moving	Water reservoir is full.	Drain the water reservoir before moving (see <b>Section 6.2 How to Drain the Unit</b> ).
	The drainage plug may be cracked.	Check the drain stop plug for cracks
Display not on	Power plug and socket contact bad or power cord disconnect, no power.	Check the power plug, power cord or socket and connect it again.
There is unusual sound	It is normal to have a slightly stronger vibration sound in the first few minutes after power-up.	Will disappear after few minutes.
Water beads on the surface	In areas of relatively high humidity, air outlet, control panel, and other parts may produce condensation.	It is a normal phenomenon.
	Long-term cooling operation in open spaces with windows open.	Closing windows, doors, etc. may resolve excessive condensation.
	Low fan speed may also lead to increased condensation.	Increase the fan speed.
	The opening angle of the louvers (adjustable vents) is too small.	Increase the angle of the louvers (adjustable vents) or set it to Oscillate mode.

When the RolliCool encounters errors, the display may show certain error codes. Refer to the table below.

Code	Possible Cause	Solution(s)
E0	Communication faults between main PCB and display PCB.	Check the wire harness of the display PCB for damage.
E1	Ambient temperature sensor failure.	Check connection or replace it. To clean or replace the temperature sensor.
E2	Coil temperature sensor failures.	Check connection or replace it. To clean or replace the temperature sensor
Ft	Condensate water high level alarm.	Empty the drain pan by removal the rubber plug.

If none of the above information resolves your issue, please visit our website at [www.rollibot.com](http://www.rollibot.com) or contact customer service at 1-844-585-6295.

## Section 9. Warranty

### 9.1 – Violation

The RolliCool 410 Portable AC Unit cannot be repaired or serviced within its warranty period if any of the following has occurred:



*The warranty has expired*

*Damage occurred during or in relation to non-routine and/or unauthorized disassembly*

*Failure to provide a valid proof of purchase when requesting service or repair*

*Damage occurred as a result of natural disaster etc.*

*Damage occurred due to unexpected factors or man-made reasons (including mis-operation, fluid found in any openings, improper insertion or pulling, hauling, bumping, improper voltage input and others).*

## 9.2 – Information

### One-Year Limited Hardware Warranty

Your RolliCool 410 Portable AC Unit (“Product”) includes a One-Year Limited Hardware Warranty (“Warranty”). The Warranty covers product defects in materials and workmanship under normal use. This Warranty is limited to residents of the United States and Canada only and is available only to original purchasers. This Warranty gives you specific legal rights, and you may also have other rights which vary from state to state.

This Warranty starts on the date of your purchase and lasts for one year (the “Warranty Period”). The Warranty Period is not extended if the Product is repaired or replaced. We may change the availability of this limited warranty at our discretion, but any changes will not be retroactive.

Warranty services are provided by Rollibot Warranty Pro (“WP”). If a hardware defect arises and a valid claim is received within the Warranty Period, at its option and to the extent permitted by law, WP will: (1) repair the hardware defect by using new or refurbished parts that are equivalent to new in performance and reliability, or (2) exchange the Product with a product that is new or refurbished which is substantially equivalent to the original product. This Warranty is for one replacement only of like-items and does not cover items out of production if the product is no longer made or stocked. This Warranty is not assignable or transferable. The original purchaser may call WP’s toll-free number at 1-844-585-6295 for a service request.

When a product or part is exchanged, any replacement item becomes your property, and the replaced item becomes WP’s property. This warranty only covers technical hardware defectiveness during the warranty period and under normal use conditions. WP does not warrant the uninterrupted or error-free operation of this Product.

This Warranty does not cover any damage due to: (a) transportation; (b) storage; (c) improper use; (d) failure to follow the product instructions or to perform any preventive maintenance; (e) modifications; (f) unauthorized repair; (g) normal wear and tear; or (h) external causes such as accidents, abuse, or other actions or events beyond our reasonable control.

Important: Do not disassemble the Product. Disassembling the Product will void this Warranty. Only WP or a party expressly authorized by WP should perform service on this Product.

DISCLAIMER OF WARRANTY: THE REMEDIES DESCRIBED ABOVE ARE YOUR SOLE AND EXCLUSIVE REMEDIES AND OUR ENTIRE LIABILITY FOR ANY BREACH OF THIS LIMITED WARRANTY. OUR LIABILITY SHALL UNDER NO CIRCUMSTANCES EXCEED THE ACTUAL AMOUNT PAID BY YOU FOR THE DEFECTIVE PRODUCT, NOR SHALL WE UNDER ANY CIRCUMSTANCES BE LIABLE FOR ANY CONSEQUENTIAL, INCIDENTAL, SPECIAL, OR PUNITIVE DAMAGES OR LOSSES, WHETHER DIRECT OR INDIRECT.

SOME STATES DO NOT ALLOW THE EXCLUSION OR LIMITATION OF INCIDENTAL OR CONSEQUENTIAL DAMAGES, SO THE ABOVE LIMITATION OR EXCLUSION MAY NOT APPLY TO YOU.

THE DURATION AND REMEDIES OF ALL IMPLIED WARRANTIES, INCLUDING WITHOUT LIMITATION THE WARRANTIES OF MERCHANTABILITY AND FITNESS FOR A PARTICULAR PURPOSE ARE LIMITED TO THE DURATION OF THIS EXPRESS LIMITED WARRANTY



Copyright © 2023. Rollibot, LLC. All Rights Reserved